

SPECIFICATIONS

ELECTRICAL

FREQUENCY RANGE \_\_\_\_\_ DC TO 26.5 GHz

VSWR(MAX)  
 DC - 4 GHz \_\_\_\_\_ 1.10:1  
 4 - 8 GHz \_\_\_\_\_ 1.15:1  
 8 - 12 GHz \_\_\_\_\_ 1.20:1  
 12 - 18 GHz \_\_\_\_\_ 1.30:1  
 18 - 26.5 GHz \_\_\_\_\_ 1.50:1

POWER (AVG) \_\_\_\_\_ 2 WATTS  
 DERATED LINERARLY TO 10% AT +125 °C

IMPEDANCE \_\_\_\_\_ 50 OHMS

MECHANICAL:

OPERATING TEMP RANGE \_\_\_\_\_ -65 TO +125°C

MATERIAL:

OUTER CONDUCTOR \_\_\_\_\_ STAINLESS STEEL IAW ASTM-A484 & ASTM A582, ALLOY 303, COND. A  
 CENTER CONDUCTOR \_\_\_\_\_ BERYLLIUM COPPER ALLOY C17200 OR C17300 IAW ASTM B196, COND 1/2 H  
 DIELECTRIC \_\_\_\_\_ PRFE (VIRGIN TEFLON) IAW ASTM-D1710-91a, TYPE 1, GRADE 1, CLASS A

FINISHES:

OUTER CONDUCTOR \_\_\_\_\_ NICKEL PLATE PER QQ-N-290, CLASS 2, .000100/.000150 THICK OVER COPPER FLASH PER MIL-C-14550.  
 CENTER CONDUCTOR \_\_\_\_\_ GOLD PLATE PER ASTM-B488 OR MIL-G-45204, TYPE II, GRADE C, .000100/.000150 THICK OVER NICKEL PLATE PER QQ-N-290, CLASS 2, .000050/.000150 THICK OVER COPPER FLASH PER MIL-C-14550 (COPPER FLASH OPTIONAL)

MARKING

PART IS UNMARKED

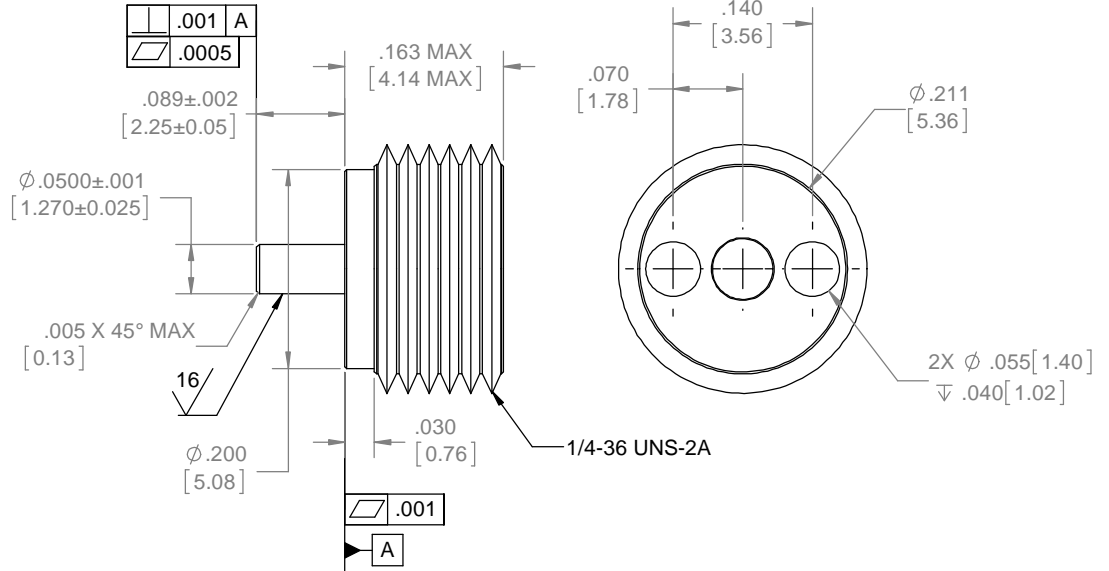
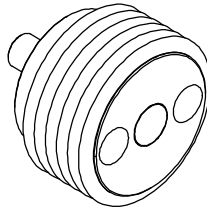

REVISIONS				
REV	DESCRIPTION	ECO #	DATE	APPROVED
-	INITIAL RELEASE	14-373	11/5/14	T.KUHN

QTY.	PART NUMBER	DESCRIPTION	ITEM NO.
X	9501-5003-10	TERMINATION, THREAD-IN, 2W	
1	TA-9501-5003-10U	ASSY, TERMINATION, THREAD-IN, 2W, UNMARKED	1

DRAWING PRACTICES PER ANSI-Y-14.5 MIL-STD-100 & 1000	
DIMENSIONS ARE IN INCHES AND APPLY BEFORE / AFTER PROCESSING	
SURFACE ROUGHNESS μINCHES	63
FINISH:	
SEE NOTES	
MATERIAL:	
SEE NOTES	
NOTE: THIS DRAWING INCORPORATES THIRD ANGLE PROJECTION.	
INTERPRET IAW ANSI Y14.5-1982	

UNLESS OTHERWISE SPECIFIED TOLERANCES IN:	
DECIMALS	INCH [MM]
.X"	.05" [1.27]
.XX"	.03" [0.76]
.XXX"	.010" [0.25]
ANGLES ±0°30'	
REMOVE ALL BURRS/SHARP W/ BREAK / R OF .003" TO .0005" UNLESS OTHERWISE NOTED DIAS CONCENTRIC <.003 T.I.R.	
DO NOT SCALE PRINT	

DRAWN	DATE
MCCORMICK	11/5/14
CHECKED	DATE
MCCORMICK	11/5/14
ENG. APPR.	DATE
T.KUHN	11/5/14

Phone: 603-222-2256 Fax: 603-222-2259  
 150 Dow Street, Manchester, NH 03101

TITLE

**TERMINATION, THREAD-IN, 2W**

SIZE	CAGE CODE	DRAWING NUMBER	REV
B	3HT76	9501-5003-10	-
SCALE	PLATED AREA SQ. IN	SHEET 1 OF 1	

THESE DRAWINGS AND SPECIFICATIONS ARE THE PROPERTY OF XMA CORP. OR OMNI SPECTRA AND SHALL NOT BE REPRODUCED, COPIED NOR USED - IN WHOLE OR IN PART - AS A BASIS FOR THE MANUFACTURE OR SALE OF OTHER ITEMS WITHOUT THE EXPRESS WRITTEN PERMISSION OF XMA CORP.