

SPECIFICATIONS

ELECTRICAL

FREQUENCY RANGE _____ DC TO 18 GHZ

VSWR
 DC - 4 GHz _____ 1.10:1 MAX
 4 - 12.4 GHz _____ 1.25:1 MAX
 12.4 - 18 GHz _____ 1.35:1 MAX

POWER (AVG) _____ 2 WATTS
 DERATED LINEARLY TO 10% @ 125°C

POWER (PEAK) _____ 500 WATTS MAX
 @5 μSEC PULSE WIDTH x 0.25% DUTY CYCLE

IMPEDANCE(NOM.) _____ 50 OHMS

MECHANICAL

CENTER CONDUCTOR _____ BERYLLIUM COPPER
 PER QQ-C-530. GOLD PER
 ASTM-B488

OUTER CONDUCTOR _____ STAINLESS STEEL PER
 ASTM A484 & A582, CLASS
 303, COND. A. PASSIVATED
 PER ASTM A380

HOUSING _____ BRASS WITH TRI-ALLOY
 PLATING

DIELECTRIC _____ TEFLON PER ASTM D1710

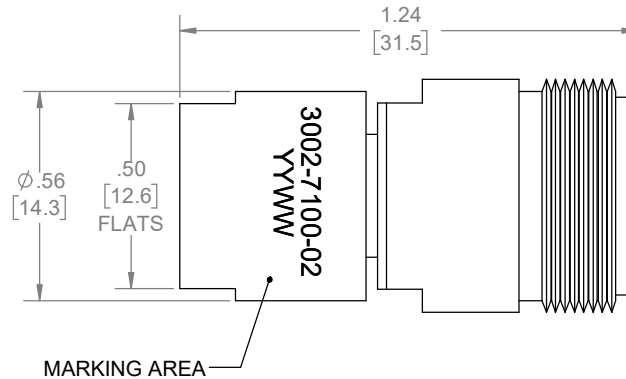
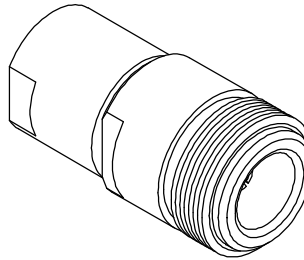

MARKING

PART LOOKS LIKE PRODUCT IMAGE ABOVE.
 PART MARKING ORIENTATION AND FORMAT AS SHOWN.
 MARKING TO BE AS LARGE AS POSSIBLE, CLEAR, READABLE.
 YYWW EQUALS DATE CODE.

REVISIONS				
REV	DESCRIPTION	ECO #	DATE	APPROVED
A	UPDATE FORMAT; SHOW MARKING	19-051	5/7/19	T.KUHN

QTY.	PART NUMBER	DESCRIPTION	ITEM NO.
X	3002-7100-02	TERMINATION, TYPE N-f, 18GHz, 2W	
1	TA-3002-7106-02U	ASSEMBLY, TERMINATION, TYPE N-f, 6GHz, 2W, UNMARKED	1

DRAWING PRACTICES PER ANSI-Y-14.5 MIL-STD-100 & 1000	
DIMENSIONS ARE IN INCHES AND APPLY BEFORE / AFTER PROCESSING	
SURFACE ROUGHNESS μINCHES	63
FINISH:	
SEE NOTES	
MATERIAL:	
SEE NOTES	
NOTE: THIS DRAWING INCORPORATES THIRD ANGLE PROJECTION.	
INTERPRET IAW ANSI Y14.5-1982	

UNLESS OTHERWISE SPECIFIED TOLERANCES IN:	
DECIMALS	INCH (MM)
.X"	.05" [1.27]
.XX"	.03" [.76]
.XXX"	.010" [.25]
ANGLES ±0°30'	
REMOVE ALL BURRS/SHARP W/ BREAK / R OF .003" TO .0005" UNLESS OTHERWISE NOTED DIAS CONCENTRIC <.003 T.I.R.	
DO NOT SCALE PRINT	

DRAWN	DATE
MCCORMICK	10/01/14
CHECKED	DATE
MCCORMICK	10/01/14
ENG. APPR.	DATE
T.KUHN	10/01/14

Phone: 603-222-2256 Fax: 603-222-2259
 150 Dow Street, Manchester, NH 03101

TITLE

TERMINATION, TYPE N-f, 18GHz, 2W

SIZE	CAGE CODE	DRAWING NUMBER	REV
B	3HT76	3002-7100-02	A
SCALE	PLATED AREA SQ. IN	SHEET 1 OF 1	

THESE DRAWINGS AND SPECIFICATIONS ARE THE PROPERTY OF XMA CORP. OR OMNI SPECTRA AND SHALL NOT BE REPRODUCED, COPIED NOR USED - IN WHOLE OR IN PART - AS A BASIS FOR THE MANUFACTURE OR SALE OF OTHER ITEMS WITHOUT THE EXPRESS WRITTEN PERMISSION OF XMA CORP.