

SPECIFICATIONS

ELECTRICAL

FREQUENCY RANGE _____ DC - 6 GHz
 VSWR
 DC - 2.5 GHz _____ 1.10:1 MAX
 2.5 - 6 GHz _____ 1.20:1 MAX
 INPUT POWER _____ 2 WATTS AVG. @ 25°C
 DERATES LINEARLY TO 1W @ 125°C
 PEAK POWER _____ 250 WATTS
 (5mSec PULSE WIDTH, .05% DUTY CYCLE)
 IMPEDANCE _____ 50 OHMS
 OPERATING TEMP RANGE _____ -40°C TO +120°C

MECHANICAL

CONNECTOR BODY _____ BRASS, TRI-ALLOY PLATED*
 CENTER CONDUCTORS _____ GOLD PLATED BRASS OR BERYLLIUM COPPER
 INSULATORS _____ PTFE (TEFLON) IAW ASTM-D1710

NOT A HERMETIC SEALED UNIT

*TRI-ALLOY IS EQUIVALENT TO ALBALLOY AND WHITE BRONZE. THIS IS A Sn, Z, Cu ALLOY USED FOR PROTECTION AND REDUCED 3rd ORDER INTERMODULATION.

RoHS DEVICE

MARKING INSTRUCTIONS

PART LOOKS LIKE PRODUCT IMAGE ABOVE.
 PART MARKING ORIENTATION AND FORMAT AS SHOWN
 MARKING TO BE AS LARGE AS POSSIBLE BE, CLEAR, READABLE.
 YYWW EQUALS DATECODE.

REVISIONS				
REV	DESCRIPTION	ECO #	DATE	APPROVED
-	INITIAL RELEASE	16-170	8/9/16	T.KUHN

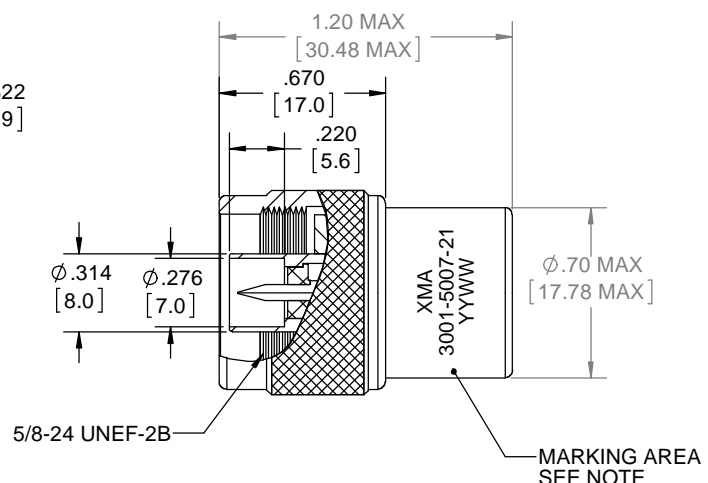
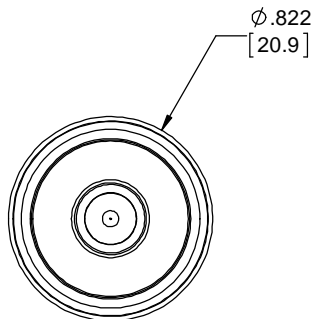

QTY.	PART NUMBER	DESCRIPTION	ITEM NO.
	3001-5007-21	TERMINATION, TYPE N, DC-6GHz, 2 WATTS AVG., 250 WATTS PEAK	-
1	5009-97-0121	TERMINATION, TYPE N, DC-6GHz, 2 WATTS AVG., 250 WATTS PEAK, UNMARKED	1

DRAWING PRACTICES PER ANSI-Y-14.5 MIL-STD-100 & 1000
 DIMENSIONS ARE IN INCHES AND APPLY BEFORE / AFTER PROCESSING
 SURFACE ROUGHNESS μ INCHES 63
 FINISH:
 SEE NOTES
 MATERIAL:
 SEE NOTES
 NOTE:
 THIS DRAWING INCORPORATES THIRD ANGLE PROJECTION.

 INTERPRET IAW ANSI Y14.5-1982

UNLESS OTHERWISE SPECIFIED TOLERANCES IN:
 DECIMALS INCH [MM]
 .X* .05" [1.27]
 .XX* .03" [.76]
 .XXX* .010" [.25]
 ANGLES $\pm 0^{\circ}30'$
 REMOVE ALL BURRS/SHARP W/ BREAK / R OF .003" TO .0005"
 UNLESS OTHERWISE NOTED DIAS CONCENTRIC <.003 T.I.R.
 DO NOT SCALE PRINT

DRAWN DATE
 MCCORMICK 8/9/16
 CHECKED DATE
 MCCORMICK 8/9/16
 ENG. APPR. DATE
 T.KUHN 8/9/16

XMA Omni SpectraSM

Phone: 603-222-2256 Fax: 603-222-2259
 150 Dow Street, Manchester, NH 03101

TITLE
**TERMINATION, TYPE N, DC-6GHz,
 2 WATTS AVG., 250 WATTS PEAK**

SIZE B	CAGE CODE 3HT76	DRAWING NUMBER 3001-5007-21	REV -
SCALE	PLATED AREA SQ. IN	SHEET 1 OF 1	

D

C

B

A

D

C

B

A