

4

3

2

1

REVISIONS				
REV	DESCRIPTION	ECO #	DATE	APPROVED
-	INITIAL RELEASE	16-184	9/8/16	T.KUHN
A	ADDED TABLE	18-113	7/26/18	T.KUHN

ELECTRICAL SPECIFICATIONS

FREQ. RANGE _____ DC TO 18 GHz

VSWR
 DC - 6GHz _____ 1.15:1 MAX
 6 - 18GHz _____ 1.25:1 MAX

ATTENUATION ACCURACY
 DC-6 GHz 6-18 GHz
 0, 3, 6, 10 dB _____ ±0.5 dB ±0.6 dB
 20 dB _____ ±0.5 dB ±0.75

POWER _____ 2 WATT AVG. @ 25°C
 DERATES LINEARLY TO 10% @ 125°C

PEAK POWER _____ 50 WATTS MAX.
 (5uSec PW, 0.05% DUTY CYCLE)

IMPEDANCE _____ 50 OHMS NOM.

TEMPERATURE RANGE _____ -55°C TO +125°C

MATERIAL

BARREL _____ STAINLESS STEEL IAW
 ASTM-A484 & ASTM-A582,
 ALLOY 303, COND A

SMPM HOUSINGS _____ BERYLLIUM COPPER

SMPM CONTACTS _____ BERYLLIUM COPPER

DIELECTRIC _____ TEFLON

OPERATING TEMP _____ -65°C TO +125°C

FINISH

BARREL _____ PASSIVATED

SMPM HOUSINGS _____ GOLD PLATED IAW MIL-G-45204,
 TYPE II, CLASS 1

SMPM CONTACTS _____ GOLD PLATED IAW MIL-G-45204,
 TYPE II, CLASS 1

MARKING:
 PART LOOKS LIKE PRODUCT IMAGE ABOVE
 PART MARKING AND ORIENTATION AND FORMAT AS SHOWN
 MARKING TO BE AS LARGE AS POSSIBLE, CLEAR, AND READABLE.
 REPLACE dB WITH THE ONE OR TWO DIGIT VALUE FROM THE WORK ORDER.
 YYWW EQUALS DATE CODE

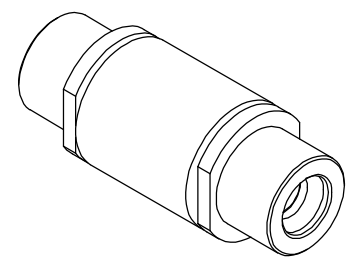
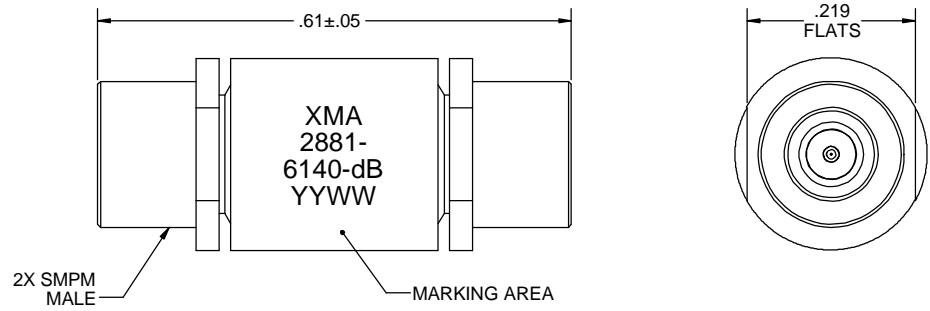

QTY.	PART NUMBER	DESCRIPTION	ITEM NO.
X	2881-6140-dB	ATTENUATOR, SMPM-m/m, 2W, DC-18GHz	
1	TA-2881-6140-dBU	ASSEMBLY, ATTENUATOR, SMPM-m/m, 2W, DC-18GHz, UNMARKED	1

<small>DRAWING PRACTICES PER ANSI Y14.5 DIMENSIONS ARE IN INCHES AND APPLY BEFORE/AFTER PROCESSING</small> SURFACE FINISH 63 ✓ FINISH: SEE NOTES MATERIAL: SEE NOTES NOTE: THIS DRAWING INCORPORATES THIRD ANGLE PROJECTION. 	<small>UNLESS OTHERWISE SPECIFIED TOLERANCES IN:</small> DECIMALS INCH (MM) .X" .05" [1.27] .XX" .03" [.76] .XXX" .010" [.25] ANGLES ±0°30' REMOVE ALL BURRS/SHARP W/ BREAK / R OF .003" TO .0005" UNLESS OTHERWISE NOTED DIAS CONCENTRIC <.003 T.I.F. DO NOT SCALE PRINT	DRAWN DATE MCCORMICK 1/20/15 CHECKED DATE MCCORMICK 1/20/15 ENG APPR. DATE T.KUHN 1/20/15 THESE DRAWINGS AND SPECIFICATIONS ARE THE PROPERTY OF XMA CORP. OR OMNI SPECTRA AND SHALL NOT BE REPRODUCED, COPIED NOR USED IN WHOLE OR IN PART AS A BASIS FOR THE MANUFACTURE OR SALE OF OTHER ITEMS WITHOUT THE EXPRESS WRITTEN PERMISSION OF XMA CORP.
---	--	---

Phone: 603-222-2256 Fax: 603-222-2259
 150 Dow Street, Manchester, NH 03103

ATTENUATOR, SMPM-m/m, 2W, DC-18GHz

SIZE C	CAGE CODE 3HT76	DRAWING NUMBER 2881-6140-dB	REV A
SCALE	PLATED AREA 50. IN	SHEET 1 OF 1	

4

3

2

1