

5

4

3

2

1

SPECIFICATIONS

ELECTRICAL

IMPEDANCE _____ 50 OHMS.

FREQUENCY RANGE _____ DC TO 18 GHz

VSWR _____ 1.25:1 MAX

MECHANICAL

HOUSING _____ C101 COPPER, GOLD PLATED WITH WHITE BRONZE UNDERPLATE (NO NICKEL)

DIELECTRIC _____ PTFE (TEFLON) IAW ASTM-D1710

CENTER CONTACT _____ BeCu, GOLD PLATED

ENVIROMENTAL

TEMPERATURE RANGE _____ 4 KELVIN TO +125° C

RoHS COMPLIANT

MARKING

PART LOOKS LIKE PRODUCT IMAGE ABOVE.

PART MARKING ORIENTATION AND FORMAT AS SHOWN.

MARKING TO BE AS LARGE AS POSSIBLE, CLEAR, READABLE.

YYWW EQUALS DATE CODE .

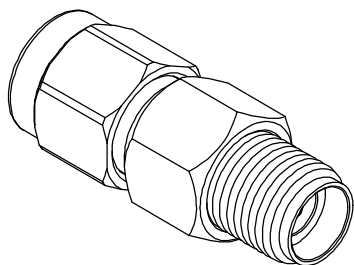

REVISIONS				
REV	DESCRIPTION	ECO #	DATE	APPROVED
X1	PRELIMINARY RELEASE		1/20/21	MES

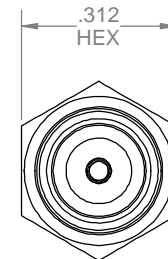
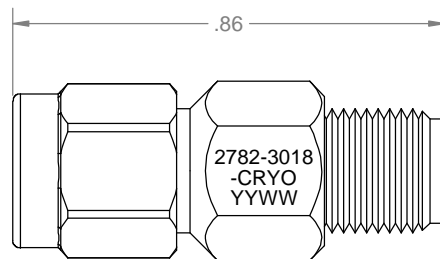

0 dB	PART NUMBER	DESCRIPTION	ITEM NO.
X	2782-3018-CRYO	ADAPTER, SMA-m/f, DC-18 GHz, CRYO	
-	TA-2782-3018U-CRYO	ASSY, ADAPTER, SMA-m/f, DC-18 GHz, CRYO, UNMARKED	

DRAWING PRACTICES PER ANSI-Y-14.5 MIL-STD-100 & 1000

DIMENSIONS ARE IN INCHES AND APPLY BEFORE / AFTER PROCESSING

SURFACE ROUGHNESS μ INCHES 63

FINISH:

SEE NOTES

MATERIAL:

NOTE: THIS DRAWING INCORPORATES THIRD ANGLE PROJECTION.

INTERPRET IAW ANSI Y14.5-1982

UNLESS OTHERWISE SPECIFIED TOLERANCES IN:

DECIMALS	INCH	[MM]
.X"	.03"	[.76]
.XX"	.010"	[.25]
.XXX"	.005	[.127]
.XXXX"	.0005"	[.013]

ANGLES $\pm 0^{\circ}30'$

REMOVE ALL BURRS/SHARP W/ BREAK / R OF .003" TO .0005" UNLESS OTHERWISE NOTED DIAS CONCENTRIC <.003 T.I.R.

DO NOT SCALE PRINT

DRAWN DATE
MCCORMICK 1/20/21

CHECKED DATE
MCCORMICK 1/20/21

ENG. APPR. DATE
JIM W 1/20/21

THESE DRAWINGS AND SPECIFICATIONS ARE THE PROPERTY OF XMA CORP. OR OMNI SPECTRA AND SHALL NOT BE REPRODUCED, COPIED NOR USED - IN WHOLE OR IN PART - AS A BASIS FOR THE MANUFACTURE OR SALE OF OTHER ITEMS WITHOUT THE EXPRESS WRITTEN PERMISSION OF XMA CORP.

Phone: 603-222-2256 Fax: 603-222-2259
7 Perimeter Road, Manchester, NH 03103

TITLE
ADAPTER, SMA-m/f, DC-18GHz, CRYO

SIZE	CAGE CODE	DRAWING NUMBER	REV
B	3HT76	2782-3018-CRYO	X1

SCALE PLATED AREA SQ. IN SHEET 1 OF 1

5

4

3

2

1